

Treble Flower Coaster Set

by Merrian Holland

US CROCHET TERMINOLOGY



Tools & Materials

Aran/Worsted weight yarn in cotton in 4 colours (A for centre of flower, B for petals, C for petal border, D for leaf toggle).

4mm / G hook.

Approximate Yardage Version 1 (white, red & yellow):

A (yellow) - 22.5 meters (24.6 yards), 15 grams.

B (red) - 22.5 meters (24.6 yards), 15 grams.

C (white) - 60.0 meters (65.6 yards), 40 grams.

D (green) - 15.0 meters (16.4 yards), 10 grams.

Approximate Yardage Version 2 (yellow, lilac & white):

A (yellow) - 15.0 meters (16.4 yards), 10 grams.

B (lilac) - 45.0 meters (49.2 yards), 30 grams.

C (white) - 45.0 meters (49.2 yards), 30 grams.

D (green) - 15.0 meters (16.4 yards), 10 grams.

Finished dimensions:

12.5cm / 5 inches across.

Finished size & yardage will vary depending on hook size, yarn thickness & your personal gauge.

Key

beg - beginning

ch – chain

dc – double crochet

hdc – half double crochet

prev - previous

sk – skip

rnd(s) – round(s)

sc(s) – single crochet(s)

sl st – slip stitch

st(s) – stitch(es)

tr – treble crochet

Alternative Yarn Thickness

You can also make these with DK or Sport weight for a smaller motif – these would make lovely re-usable face scrubbies/makeup removers. Try a 3.5mm / E or 3mm / D hook.

Recommended yarn:

Hobbii Rainbow 8/8 Organic. Technically this yarn is classed as DK weight but it's very thick for a DK, more like a worsted weight.

Instructions

(colourway 2 – see page 13)

Use colour A to make the centre sc ring

Chain 6. Slip stitch into first chain to make a ring.

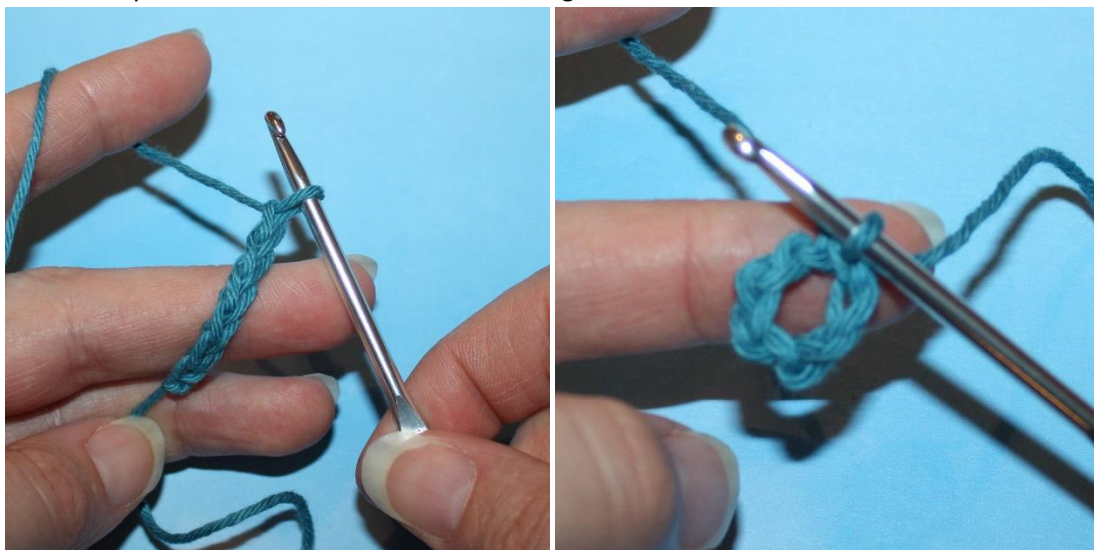

Single crochet 15 times into the ring. You may need to shunt the stitches along with your fingers as you go, to ensure that all 15 will fit into the ring.



Join with a slip stitch into first single crochet and fasten off.



Use colour B to make the centre treble crochet section, including petals.

Join yarn to any sc stitch. Chain 4 and then treble crochet (tr) into the same stitch (*see page 8 for treble crochet instructions*).

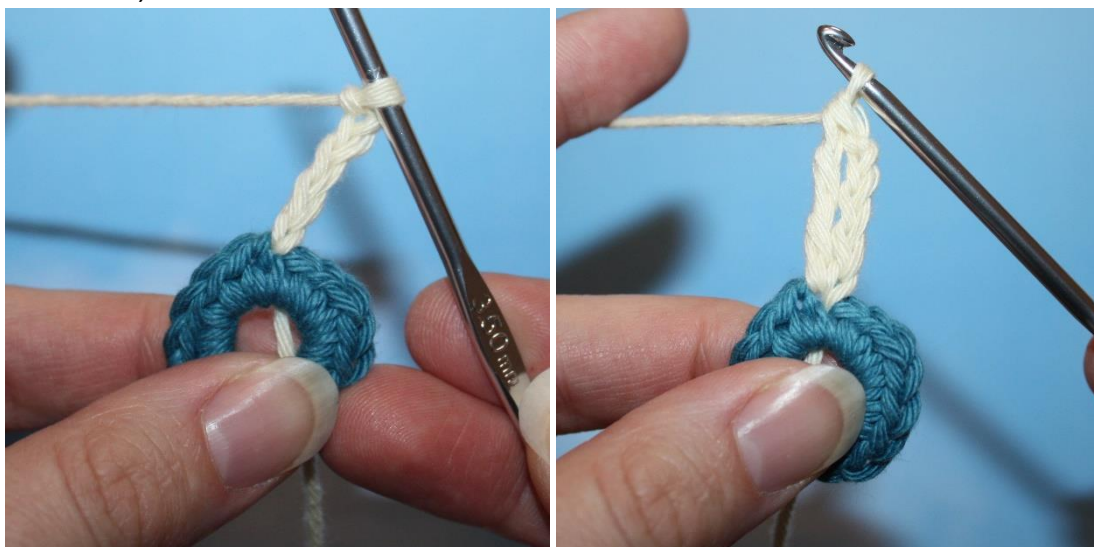

Continue all around, making 2 treble crochet stitches into each single crochet stitch from the starting ring. You should have 30 treble crochet stitches. Finish with a slip stitch into the top of the first chain 4.

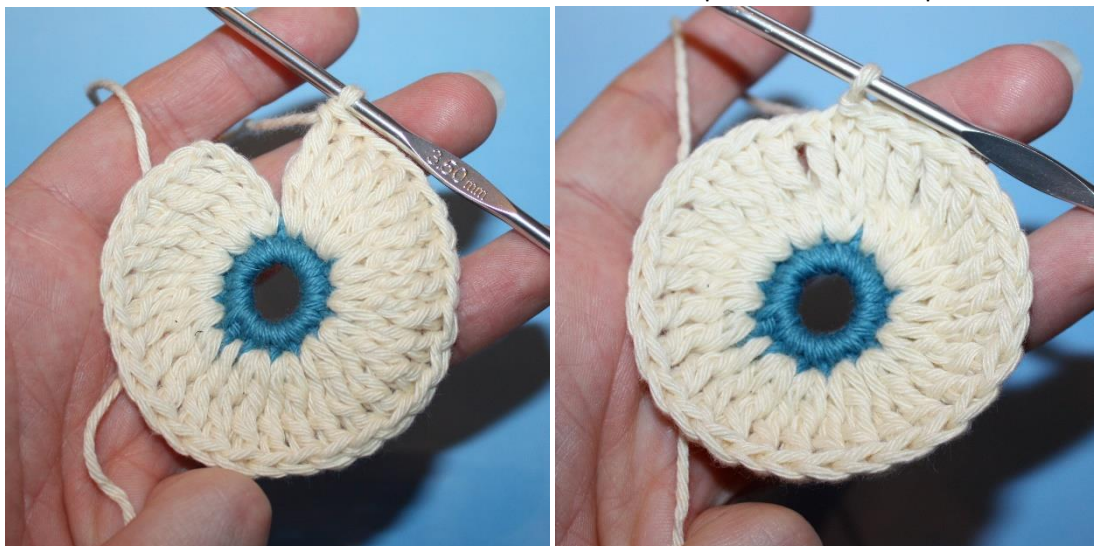

You will now start to make the petals by creating treble crochet clusters or shells.

Skip the next two stitches and treble crochet into the 3rd stitch. Treble crochet into the same stitch another 10 times (each petal is made up of 11 treble crochets). Skip the next two stitches and secure the petal with a slip stitch



Continue in this way until you have 5 petals, securing the last petal with a slip stitch in the slip stitch that you finished the previous round with. Take care to only skip 2 sts each time – the first st is often hidden under the cluster/shell you've just made.

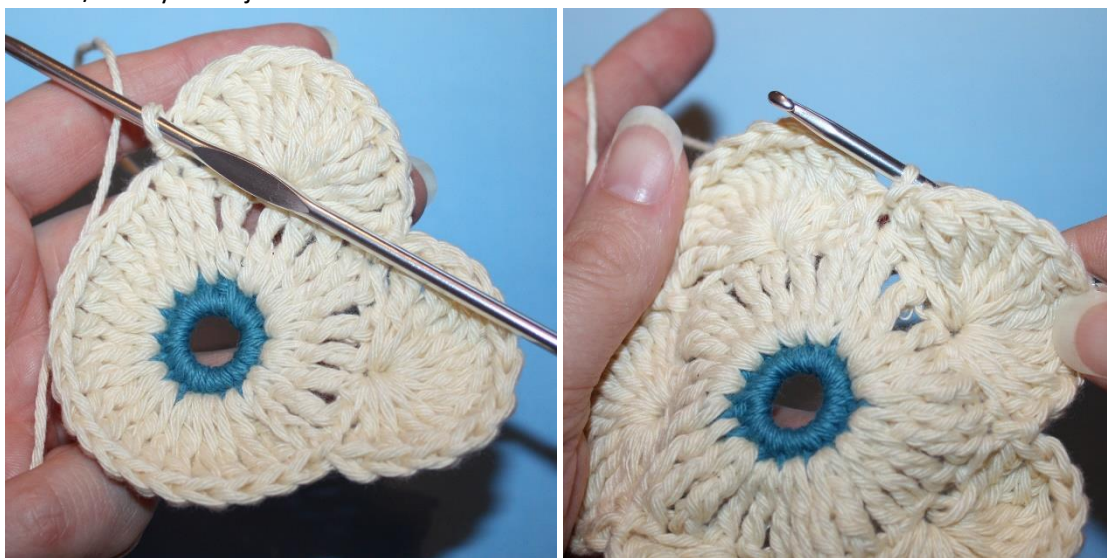

You should now have a five petal flower that looks like this:



Use colour C to make the single crochet border.

Join yarn to any petal stitch as long as it is not the first or last stitch of the petal. Join with a slip stitch and then single crochet twice into the same stitch.

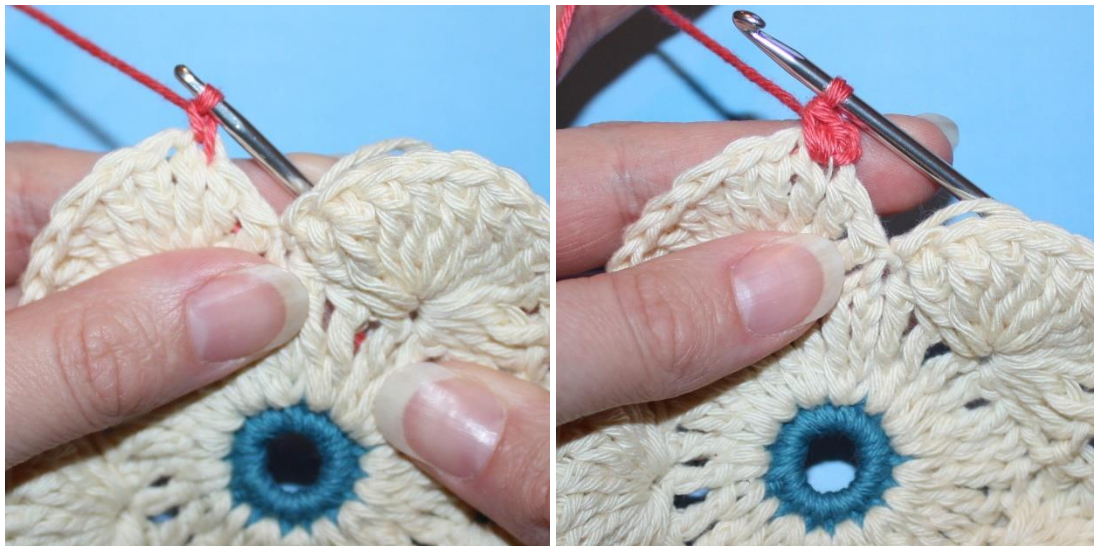

Single crochet twice into each stitch until you come to the last treble of the petal, only single crochet once into this stitch.

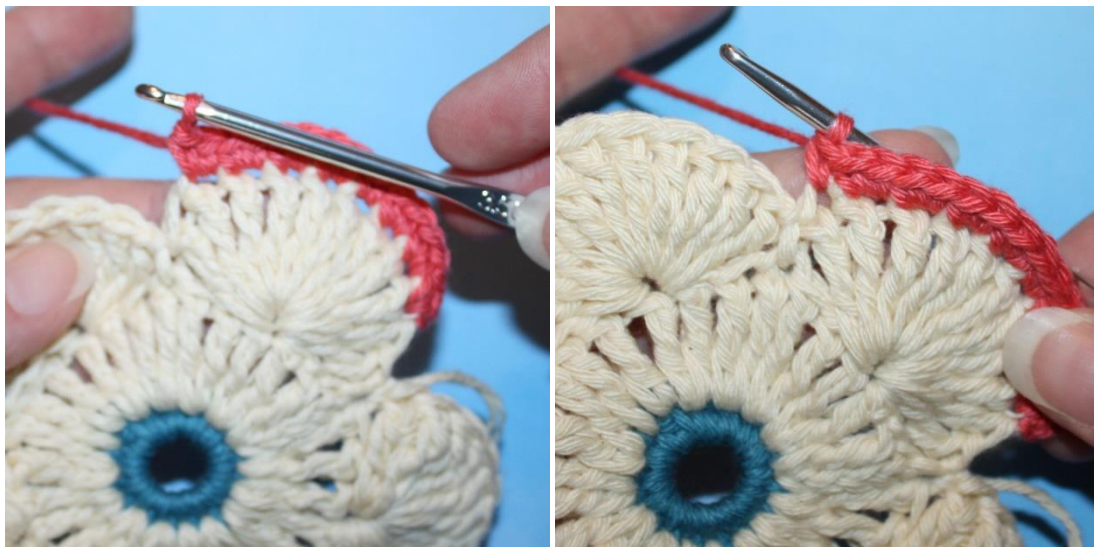

Skip the slip stitch and then single crochet once into the first treble of the next petal. Single crochet twice into each of the next stitches, but only single crochet once into the last treble of the petal.



Continue in this way: two single crochets in each stitch, one single crochet in the last and first stitch and skipping the slipped stitches.

If you have a loose gauge, 2 sc in each stitch may result in a rippled edge. If this is the case, alternate between 1sc & 2sc in each stitch or switch to a smaller hook.

Join with a slip stitch into first single crochet and finish off. A sewn bind off is best.



Make 4 lots of flowers. Press with a damp cloth and hot iron to neaten and flatten.

How to treble crochet (UK Double Treble)

1. Yarn over twice.

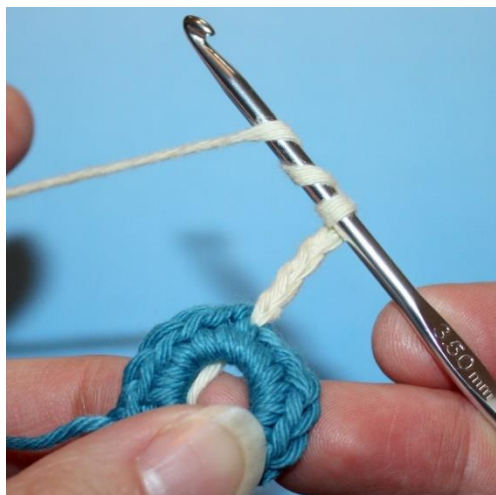

2. Insert hook into stitch and pull up a loop (4 loops on hook).



3. Pull a loop through the first two stitches on hook (3 loops remain on hook).



4. Pull up another loop through the next two stitches on hook (2 loops remain on hook).



5. Pull up a final loop through the last two stitches on hook. 1 treble crochet complete!



Leaf Toggle for Treble Flower Coasters

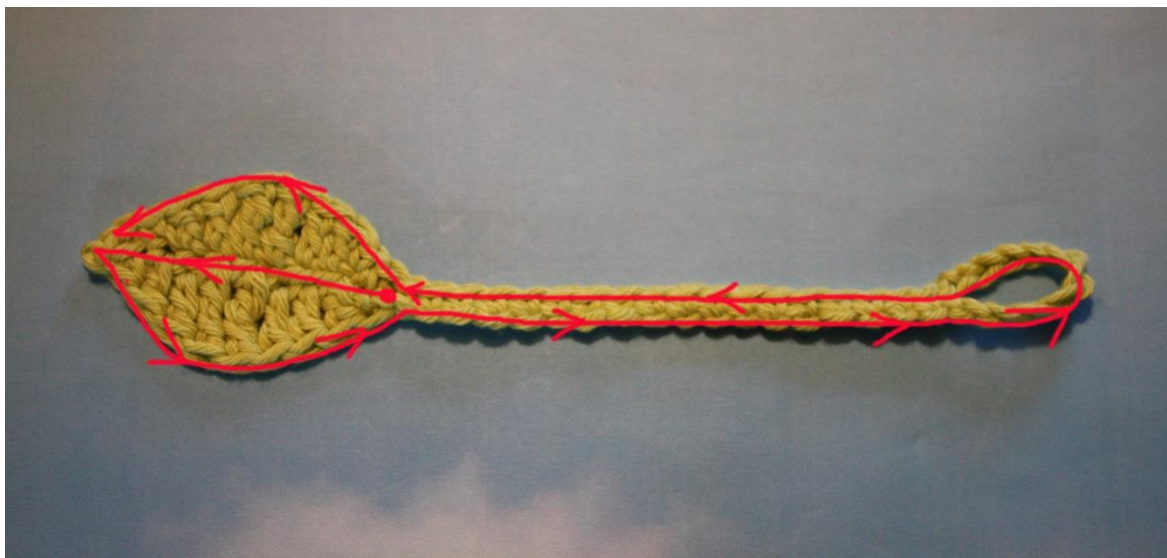

The bottom side of the leaf is worked through the top loop of the chain, then you make the stalk, come back along the stalk chain to make the top of the leaf through the bottom loop (which then becomes the top loop as you have rotated your work).

Use colour D to make the leaf & stalk.

Chain 10. Sc in 2nd chain from hook – going through the left loop only or top loop if your chain is lying horizontally. Continue working into the chain this way as you make this first side of the leaf.

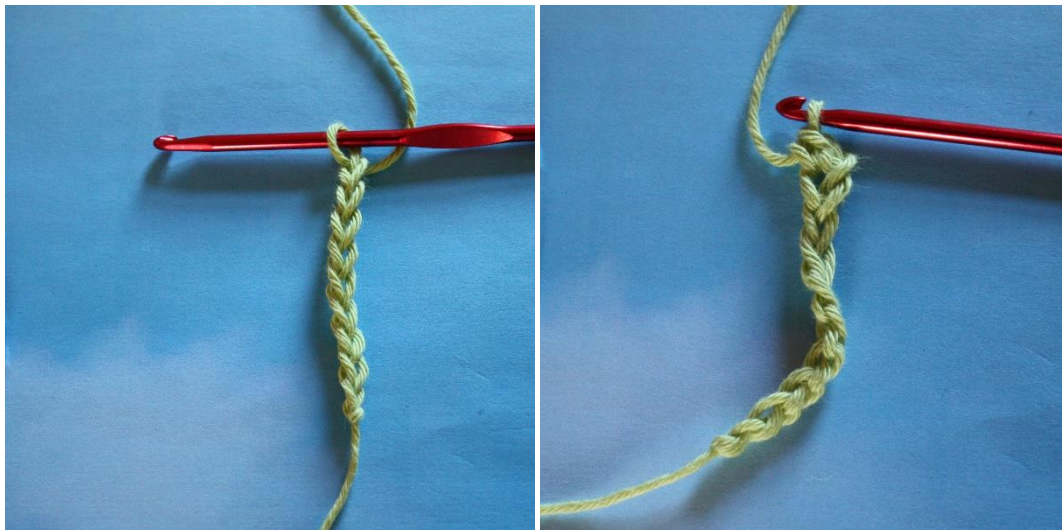

1dc into each of the next 2 chains. 1trc into each of the next 2 chains.

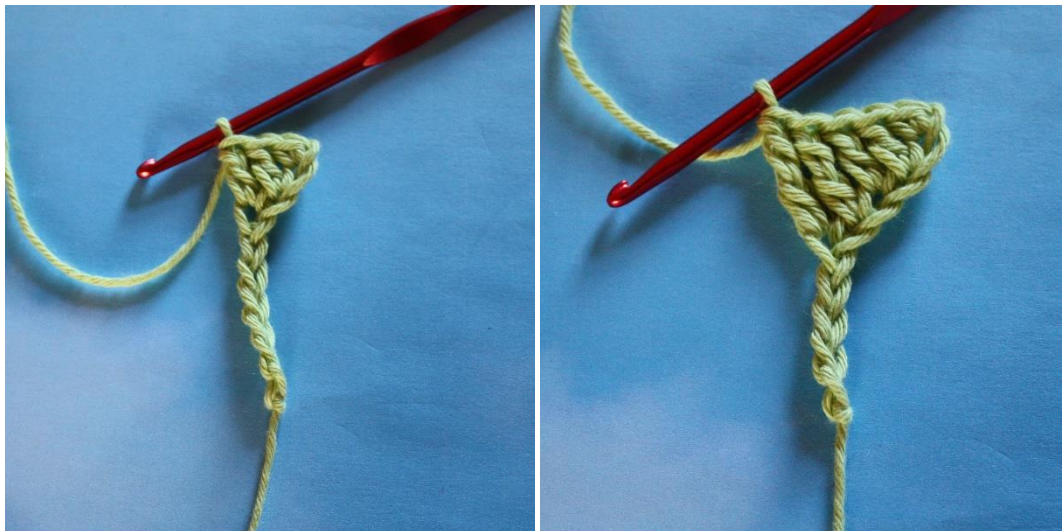

1dc into each of the next 2 chains. 1sc into each of the next 2 chains.



Now chain 17 for the stalk. Continue to chain another 12 for the loop of the stalk & then sc into 13th chain from hook – going through both loops of the chain, i.e. left & right loops if your chain is vertical, top and bottom if your chain is horizontal – the back ridge of the chain should remain empty.



Continue to sc in each full chain until you reach the bottom of your leaf. TWIST THE LEAF ROUND so that the correct side faces you.



Now you will work into the other side of the first chain section you made – there will only be one loop available. 1sc into the next st. 1hdc into the next.



1tr into each of the next 2 stitches. 1dc into each of the next 2 stitches. 1hdc into the next.



1sc into each of the last 2 stitches. Finish with a slip stitch into the sc of the very first leaf stitch.



Fasten off. Weave in your ends – weave the end at the tip of the leaf down the centre of the leaf to help make it sturdier.



Weave the start tail down into the stalk. Your leaf/stalk toggle may start to curl – don't worry about this as it will straighten out once in use.



With the right sides of your coasters facing towards you, thread the loop end of your stalk through the centre of the flowers. Thread the leaf through the loop.



You may find that your first attempt is not the correct size – the stalk may be too short or too long. This will be because your gauge is different to mine and/or you have used a different sized hook or thickness of yarn and your coasters may be bigger or smaller than mine.

If this is the case, you can adjust the size by simply chaining more or less than the 17 chains I have used for this pattern. I'm afraid there is a certain element of guesswork involved in getting it just the right size.

Thank you for trying out my pattern!

I love seeing what you have made, please share on Instagram @mezzamay.

Make to Sell

You may make these coasters to sell, either for charity or personal profit if you are a small scale crafter. All I ask is that you place the following text credit, either in your online listing or on a small piece of paper with the finished item: ***Design from www.mezzacraft.com***

You may not use the pattern for large scale, commercial manufacturing.

